

800 7812
 8008500
 8009164
 8009367
 8009369
 8011991
 8011993

DETAIL (A)

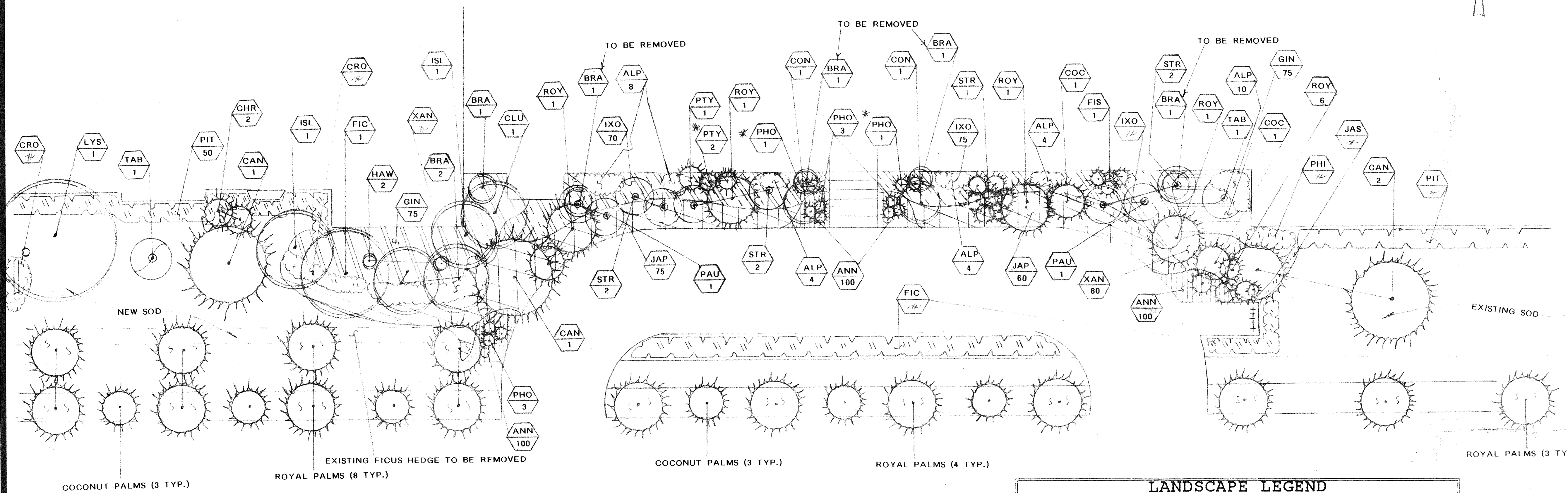

AUSTRALIAN AVENUE

NOTES:

- SEE SPECIFICATION SHEET FOR ADDITIONAL DETAILS.
- LANDSCAPE CONTRACTOR TO COORDINATE LOCATION OF TREES & PALMS WITH LANDSCAPE ARCHITECT PRIOR TO INSTALLATION.
- LANDSCAPE CONTRACTOR TO REPAIR OR SUPPLY LAWN IRRIGATION TO ALL LANDSCAPED AREAS GUARANTEERING 100% AND MAINTAIN A 50% OVERLAP. SYSTEM SHALL HAVE A RAIN SENSOR AS REQUIRED.
- ALL LANDSCAPE MATERIAL SHALL BE "FLORIDA FANCY".

LANDSCAPE LEGEND

CODE	AMOUNT	BOTANICAL NAME/Common Name	SIZE	REMARKS
CON	2	CONOCRUPUS ERECTUS/SILVERBUTTNWD.	14'-16"X7'	F.G.
IXO	145	IXORA NORA GRANT/PINK IXORA	24"3GAL	24" O.C.
XAN	80	PHILODENDRON XANADU/"XANADU"	24"3GAL	24" O.C.
GIN	150	ALPINIA ZERUMBET/VARIGATED GINGER	24"3GAL	24" O.C.
JAP	135	BUXUS MICROPHYLLA/JAPANESE BOXWOOD	8"3GAL FULL	24" O.C.
ANN	300	SEASONAL ANNUALS/L.A.SELECT	4 1/2" POTS	12" O.C.
PIT	50	PITOSPORUM TOBIRA/GREEN PITTS.	30"3GAL	24" O.C.
TAB	2	TABABUIA CARAIBA/YELLOW TRUMPET	18'-20"X10'	F.G.
STR	7	STRELITZIA NICOLA/WHITE BIRD PARADISE	14'-16"X6' MULTI-STEM	F.G.
PAU	2	PAUROTIS WRIGHTII/EVERGLADES PALM	14'-16"X6' MULTI-STEM	F.G.
COC	8	COCOS NUCIFERA/COCONUT PALM	EXISTING	TO REMAIN
FIC	1	FICUS LYRATA/FIDDLE LEAF FIG	"	"
BRA	7	SCHEFFLERA ACTINOPHYLLA/UMBRELLA	"	" REMOVE 4
CAN	4	PHOENIX CANARIENSIS/CANARY ISL.PALM	"	"
LYS	1	LYSILOMA LATISILLIQUA/WILD TAMARIND	"	"
ISL	2	ARAUCARIA HETEROPHYLLA/NORTHFOLK	"	"
CLU	1	CLUSIA ROSEA/PITCH APPLE	"	"
HAW	2	CORDYLINE TERMINALIS/HAWAIIAN TI	"	"
XAN	4	PHILODENDRON XANADU/"XANADU"	"	"
CRO	4	CODIAEUM VARIGATUM/CROTON	"	"
PIT	4	PITOSPORUM TOBIRA/GREEN PITTS.	"	"
PHO	9	PHOENIX ROEBELLINI/DWF.DATE PALM	8'-8"HT. DOUBLE	ADD 2 AS SHOWN
PTY	3	PTYCHOSPERMA ELEGANS/ALEXANDER	16'-18"HTS.	ADD 2 AS SHOWN
PHI	4	PHILODENDRON SELLOUM/SPLIT LEAF	"	"
JAS	4	JASMINUM VOLUBILE/WAX JASMINE	"	"
STR	1	STRELITZIA NICOLA/WHITE BIRD PARADISE	"	"
ALP	30	ALPINIA PURPURATA/RED/PINK GINGER	3'-4"HT.	10 GAL
ROY	19	ROYSTONIA ELATA/FL.ROYAL PALM	EXISTING	TO REMAIN

REVIEWED
 WITHOUT CONDITIONS
 WITH CONDITIONS
 SUBJECT TO THE FOLLOWING SPECIFIED CHANGES
 SEE BELOW

A Reviewed this 18TH day of DEC 1996
 TOWN OF PALM BEACH
 Landmark Preservation Commission
 LPC Chairman
 CERTIFICATE OF APPROPRIATENESS NO. 50-96

Part of CoA # 50-96
 12/18/96
 Approved as presented for south elevation and the courtyards as presented, with the proviso that a wishing well is replaced at the site in the stipulated location.
RECEIVED
 DEC 17 1996
 TOWN OF PALM BEACH
 BUILDING & ZONING

REVISIONS	BY
10/17/96	RGB
ADD LANDS	RGB
12/11/96 REV.PER	RGB
OWNER	RGB

R. BARTLETT LANDSCAPE, INC.
 14417 STIRRUP LANE
 WELLINGTON, FL. 33414
 (861) 795-0443
 CARL B. HIGGINS #0001436 ASLA

LANDSCAPE PLAN

Project: **BRAZILIAN COURT**
 301 AUSTRALIAN AVE.
 TOWN OF PALM BEACH, FL.

DRAWN	RICK BARTLETT
CHECKED	RGB
DATE	9/25/96
SCALE	1" = 10'-0"
JOB NO	96-09-1058
SHEET	